

ALUMINIUM INSTALLATION INSTRUCTIONS

XL ALUMINIUM GUTTER

1. Place gutter in position, fixing to fascia board at 500mm centres through oversize hole to allow for expansion and contraction using 32mm stainless steel screws and oversize washer.
2. Allow 2mm expansion gap between lengths and components.
3. Ensure all joint areas are clean, dry dust and grease free prior to applying silicone sealant.
4. Apply 2 no. 6mm beads of low modulus silicone to each side of joint.
5. Place joint clip in position pressing down firmly until it clips into position.
6. Using a cloth to protect the finish, press the joints into place using bent pliers.
7. Remove any surplus sealant from faces of gutter.
8. Gutter may be cut using a fine tooth hacksaw or power saw with aluminium blade. Ensure any burr is removed with a file.
9. Ensure any cut ends are coated using the touch up paint provided.
10. Brackets may be used if required. Brackets must be used with the 125 x 55mm XL half round gutter.

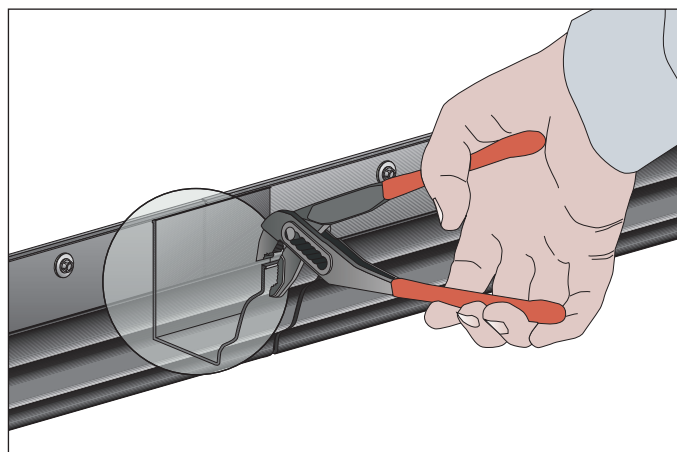
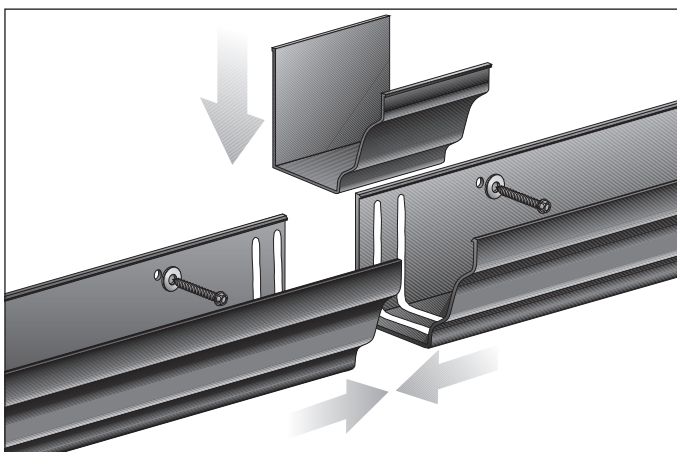

STANDARD ALUMINIUM BOX GUTTER

1. Place gutter in position, fixing to fascia board at 500mm centres through oversize hole to allow for expansion and contraction using 32mm stainless steel screws and oversize washer.
2. Allow 2mm expansion gap between lengths and components.
3. Ensure all joint areas are clean, dry, dust and grease free prior to applying silicone sealant.
4. Apply 2 no. 6mm beads of low modulus silicone to each side of joint and around each bolt hole.
5. Place joint clip in position. Drill gutter using 6mm HSS drill each side of joint.
6. Insert 25 x 5mm stainless fixing bolts from the underside of the gutter. Do not over tighten.
7. Remove any surplus sealant from faces of gutter.
8. Gutter bolts may be touched up using touch up paint provided.
9. Gutter may be cut using a fine tooth hacksaw or power saw with aluminium blade. Ensure any burr is removed with a file.
10. Ensure any cut ends are coated using the touch up paint provided.

